

CUST P/N

RoHS COMPLIANT

Patented

ZONE		REV	DESCRIPTION	DATE	APPROVED
		A	Initial Design	2013/6/30	LIGHT C
		B	Template Change	2019/6/10	Daniel C
		C	Drawing Template update	2022/2/10	Daniel C

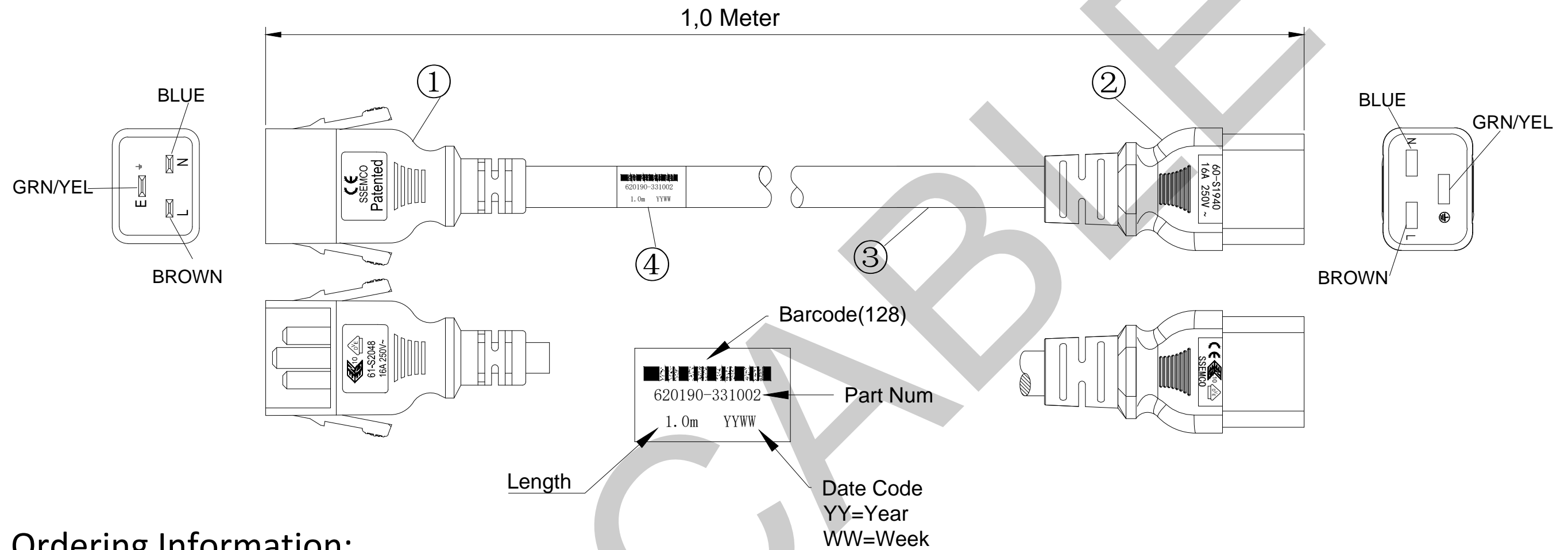

Ordering Information:

620190 - 3 3 100 2

SERIES

COLOR CODE:

0=Black,1=Gray,2=Blue,4=Green,
6=Orange,7=Red,8=Yellow,9=White

WIRE GAUGE:
3=1.5mm²

CABLE LENGTH:
For Metric System:
First digit=meter; Last two digit=cm

WIRE TYPE:
3=H05VV-F

4	Label	
3	H05VV-F 1.5mm ² /3G 70°C 300/500V~ Blue	VDE
2	IEC320 C19 16A 250V~	VDE
1	P-LOCK IEC320 C20 16A 250V~	VDE
ITEM	DESCRIPTION	APPROVAL

UNLESS OTHERWISE SPECIFIED

1) DIMENSIONS ARE IN MILLIMETERS

2) TOLERANCES ARE:

For Inch System
Cable Length < 4FT: ±1.18in
Cable Length ≥ 4FT: ±1.97in

For Metric System
Cable Length < 1000mm: ±30mm
Cable Length ≥ 1000mm: ±50mm

THIRD ANGLE PROJECTION

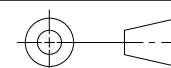

ITEM #

MK6222

MK Cable

Product Name

IEC P-LOCK POWER CORD

IEC P-LOCK C20 to C19 16A/250V

ITEM NO.

620190-331002

DWG NO.

620190-331002

SHEET

1 OF 1