

CUST P/N

RoHS COMPLIANT

Patented

ZONE		REV	DESCRIPTION	DATE	APPROVED
		A	Initial Design	2023/6/20	Daniel C

2,5 M

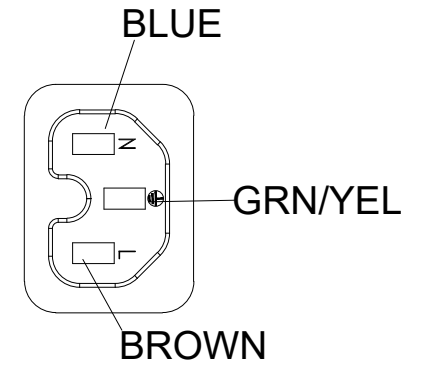
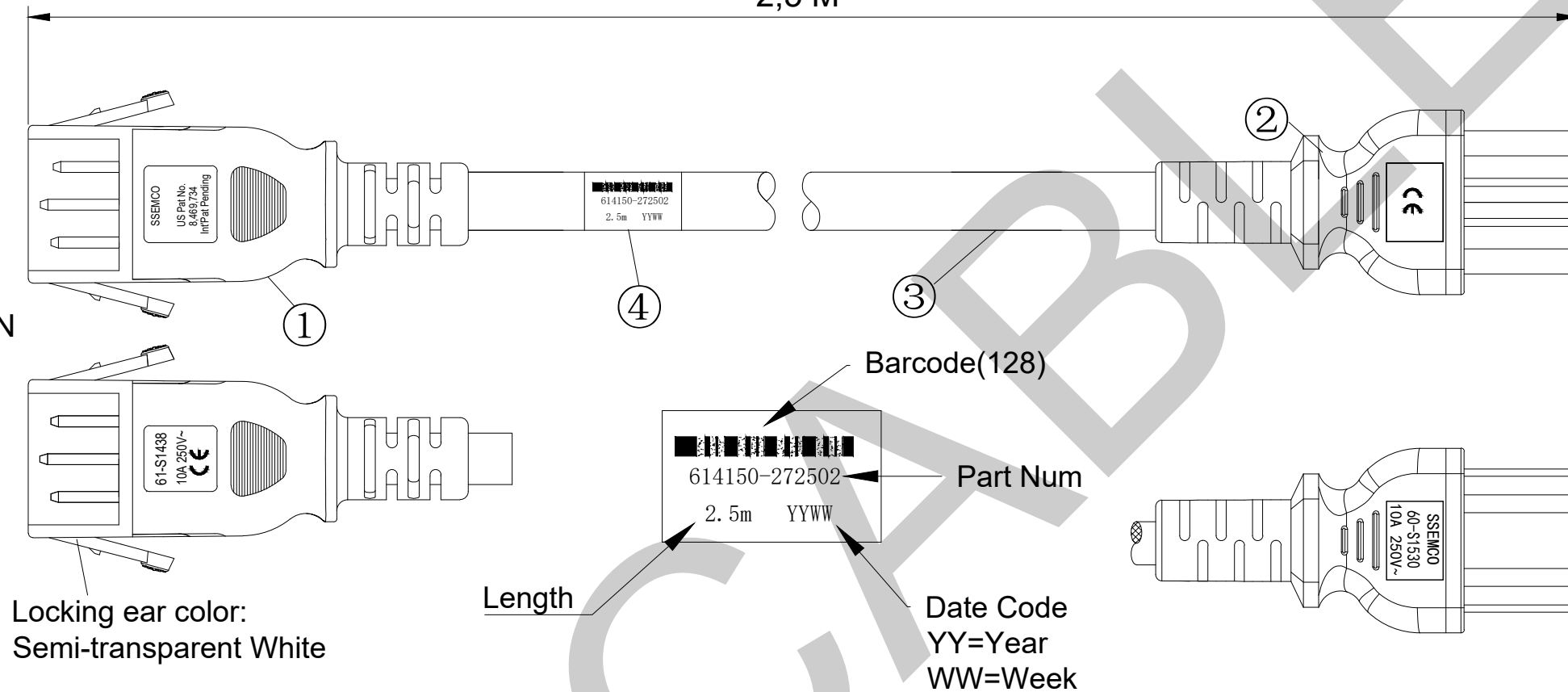
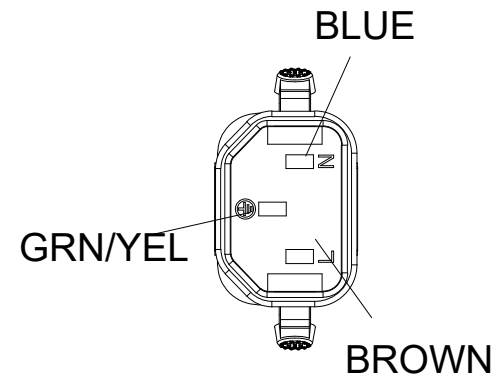

Locking ear color:
Semi-transparent White

Length

Barcode(128)

Part Num

Date Code
YY=Year
WW=Week

Ordering Information:

614150 - 2 7 250 2

SERIES

COLOR CODE:
0=Black,1=Gray,2=Blue,3=Purple,4=Green,
6=Orange,7=Red,8=Yellow,9=White

WIRE GAUGE:
2=1.0mm²

CABLE LENGTH:
For Metric System:
First digit=meter; Last two digit=cm

WIRE TYPE:
7=H05RR-F

ITEM	DESCRIPTION	APPROVAL	QTY
4	Label		1
3	H05RR-F 3*1.0mm2 Blue	VDE	1
2	IEC320 C15 10A 250V~	CE	1
1	P-LOCK IEC320 C14 10A 250V~	CE	1

UNLESS OTHERWISE SPECIFIED
1) DIMENSIONS ARE IN MILLIMETERS
2) TOLERANCES ARE:
For Inch System
Cable Length < 4FT: ±1.18in
Cable Length ≥ 4FT: ±1.97in
For Metric System
Cable Length < 1000mm: ±30mm
Cable Length ≥ 1000mm: ±50mm

THIRD ANGLE PROJECTION

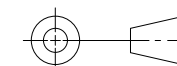

ITEM # MK6721

MK Cable

Product Name
IEC P-LOCK POWER CORD CE
IEC P-LOCK C14 to C15 10A/250V

MODEL NO. 614150-272502

DWG NO. 614150-272502

SHEET 1 OF 1