

CUST P/N

RoHS COMPLIANT

Patented

| ZONE |  | REV | DESCRIPTION             | DATE      | APPROVED |
|------|--|-----|-------------------------|-----------|----------|
|      |  | A   | Initial Design          | 2013/6/30 | LIGHT C  |
|      |  | B   | Template Change         | 2019/6/10 | Daniel C |
|      |  | C   | Drawing Template update | 2022/2/10 | Daniel C |

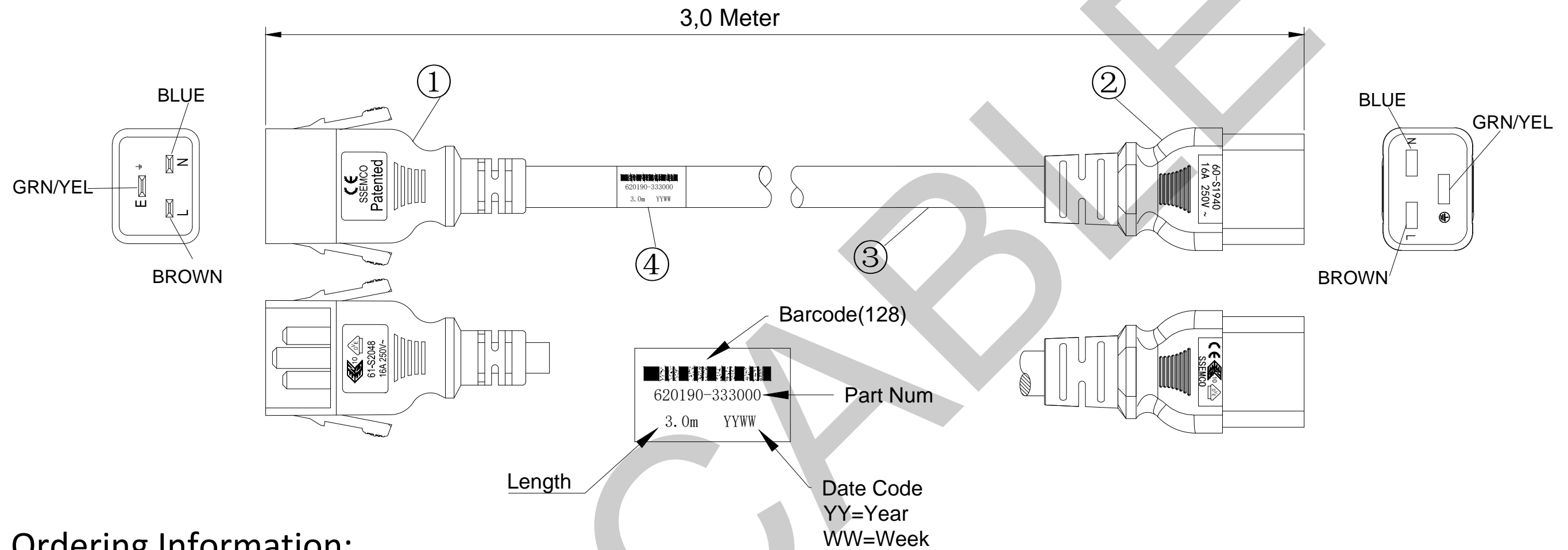

## Ordering Information:

620190 - 3 3 300 0

SERIES

COLOR CODE:

0=Black,1=Gray,2=Blue,4=Green,  
6=Orange,7=Red,8=Yellow,9=White

WIRE GUAGE:  
3=1.5mm<sup>2</sup>

CABLE LENGTH:  
For Metric System:  
First digit=meter; Last two digit=cm

WIRE TYPE:  
3=H05VV-F

| 4    | Label   |          |
|------|---|----------|
| 3    | H05VV-F 1.5mm <sup>2</sup> /3G 70°C 300/500V~ Black | VDE      |
| 2    | IEC320 C19 16A 250V~                                | VDE      |
| 1    | P-LOCK IEC320 C20 16A 250V~                         | VDE      |
| ITEM | DESCRIPTION   | APPROVAL |

UNLESS OTHERWISE SPECIFIED  
1) DIMENSIONS ARE IN MILLIMETERS  
2) TOLERANCES ARE:  
For Inch System  
Cable Length < 4FT: ±1.18in  
Cable Length ≥ 4FT: ±1.97in  
For Metric System  
Cable Length < 1000mm: ±30mm  
Cable Length ≥ 1000mm: ±50mm

THIRD ANGLE PROJECTION

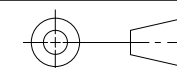

ITEM # MK6813

MK Cable

Product Name  
IEC P-LOCK POWER CORD  
IEC P-LOCK C20 to C19 16A/250V

ITEM NO. 620190-333000

DWG NO. 620190-333000

SHEET 1 OF 1